



LEDestá
premium lighting

LIFEBEING[®] sensor

Catalogue Nr.8

LEDesta, Ltd

+370 600 93111

sales@ledesta.eu

www.ledesta.eu

Sandelių g. 44, Vilnius, Lithuania

Technology Evolution

2008

The First generation planar antenna microwave detection technology.

The first one to unlock 5.8ghz planar microwave motion sensor, replacing the PIR technology, to solve the sensor lamp with complex structure, short life, susceptible to environmental changes and other problems.

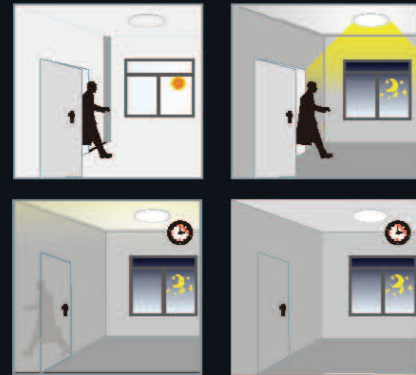

2015

The First generation planar antenna for high mounting height.

The industry first sensor to support installed 16 meters high in industrial and highbay lights, promote the use of microwave induction energy-saving schemes in high mounting environments such as warehouses, halls and museums.



2018

The First generation planar antenna microwave detection technology.

The first one to unlock 5.8GHz planar microwave motion sensor, replacing the PIR technology, to solve the sensor lamp with complex structure, short life, susceptible to environmental changes and other problems.



2020

Dipole antenna technology.

Small opening size, high gain, large beam Angle, widely used in three-proof lamp and line lamp, etc.

Solve the key pain points of short application distance and unstable performance of parking lot.

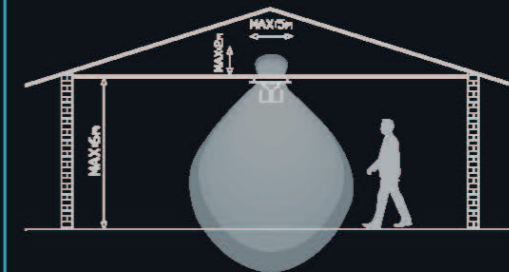

The Second generation planar antenna microwave detection technology.

RC voltage-reducing power supply, output positive and negative control relay, reduce standby power consumption, optimize product volume, reduce raw material cost.

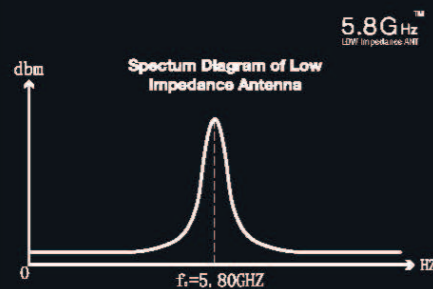

2014

Minor motion detecting technology.



Breeze and drizzle resistance technology.



2017

The First generation planar antenna for true presence detecting.



The Second generation planar antenna for high mounting height.

2019

Posture recognition detection technology.

Differential antenna and novel Disturbance rejection algorithm.



2022

Index

| | |
|--|----|
| Technology Evolution | 02 |
| Index | 04 |
| Four Core Technologies | 06 |
| Accurate Detection, Zero False Reports | 08 |
| Accurate Detection, Zero Missing Reports | 09 |
| Single Items for Full Space Management | 10 |
| Security, Intelligence, Energy Saving, IOT | 11 |
| Scene Application Category | 12 |
| Intelligent Lighting | |
| Villa/Home (Entrance) | 14 |
| Villa/Home (Living Room) | 15 |
| Villa/Home (Bedroom) | 16 |
| Villa/Home (Bathroom) | 17 |
| Villa/Home (Balcony) | 18 |
| Business Office Building (Office Lobby) | 19 |
| Business Office Building (Office Area) | 20 |
| School (Classroom) | 21 |
| Hotel (Aisle) | 22 |
| Hotel (Guest Room) | 23 |
| Hotel (Bathroom) | 24 |
| Smart Home | |
| Smart Home (Toilet) | 25 |
| Smart Home System | 26 |

Product Parameter Instruction

| | | | |
|--|----|---|----|
| 5.8GHz Lifebeing Sensor-Dry Contact Output | | 24GHz Lifebeing Sensor-Dry Contact Output | |
| MSA021D RC | 27 | MSA200D RC | 40 |
| MSA021 RC | 27 | MSA200 RC | 40 |
| MSA001D | 28 | | |
| MSA040D RC | 29 | | |
| 5.8GHz Lifebeing Sensor-Single Items Output | | 24GHz Lifebeing Sensor-Single Items Output | |
| MSA015S RC | 30 | MSA202S RC | 41 |
| MSA025S | 30 | | |
| MSA001S 1 | 31 | | |
| MSA003S RC | 32 | | |
| 5.8GHz Lifebeing Sensor-Wired Communication Signal Output | | 24GHz Lifebeing Sensor-Wired Communication Signal Output | |
| MSA017K RC | 33 | MSA201 PLC | 42 |
| MSA036D 485 | 34 | MSA203D 485 | 43 |
| MSA043D 485 | 34 | MSA206K RC | 44 |
| MSA019 | 35 | | |
| MSA039 PLC | 35 | | |
| 5.8GHz Lifebeing Sensor-Wireless Communication Signal Output | | 24GHz Lifebeing Sensor-Wireless Communication Signal Output | |
| MSA035 Z1 | 36 | MSA201 Z | 45 |
| MSA050 Z1 | 36 | MSA201 Z (Gongban) | 45 |
| MSA042D Z | 37 | MSA053 Z | 46 |
| MSA035 Z1(Gongban) | 38 | | |
| MSA050 Z1(Gongban) | 38 | | |
| 5.8GHz Lifebeing Sensor-0-10V Output | | 24GHz Lifebeing Sensor-0-10V Output | |
| MSA012 R | 39 | MSA207D RC | 47 |
| MSA012 | 39 | | |
| Daylight | | Remote Control | |
| MS10 | 48 | MH10 | 50 |
| MS13 | 49 | MH12 | 51 |

Four Core Technologies

Introduction of core technology of microwave Lifebeing sensor

01. Orthogonal distributed half wave folding antenna

Global patent orthogonal half-wave folding antenna, leading smart home, smart hotel, smart pension and other industries into full space management by a single sensor.

Based on the 24GHz international ISM frequency band, the original orthogonal half-wave bending antenna of minorite technology can achieve a large beam Angle of 105°x105° and obtain extremely high detection gain, ensuring the excellent experience of moving, minor motion and Lifebeing within 10x10m.

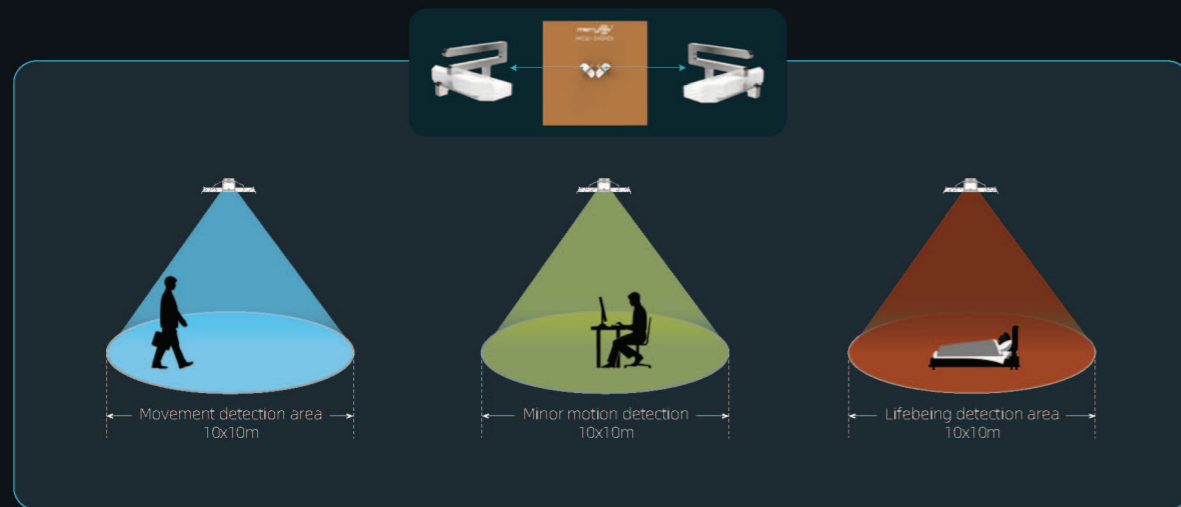

02. Lifebeing detecting

Lifebeing Sensor is based on 24Ghz microwave motion detection technology. The patented low impedance antenna and exclusive occupancy sensing algorithm are used to detect human existence by detecting the expansion of the chest and abdomen during human respiration. At the same time, the algorithm and microwave detection can effectively avoid the airow interference from air conditioning and exhaust, which achieves accurately identify the occupancy of human being. No matter in any mode of activity, meeting, reading, writing, rest or static meditation.



03. Daylight harvesting

Sensors solves the problem that the illumination sensor cannot accurately detect the illumination of the desktop through the self-developed Filar optical lens and illumination detection algorithm, and meanwhile, the lens optical imaging technology can avoid the inuence of the desktop color and material.

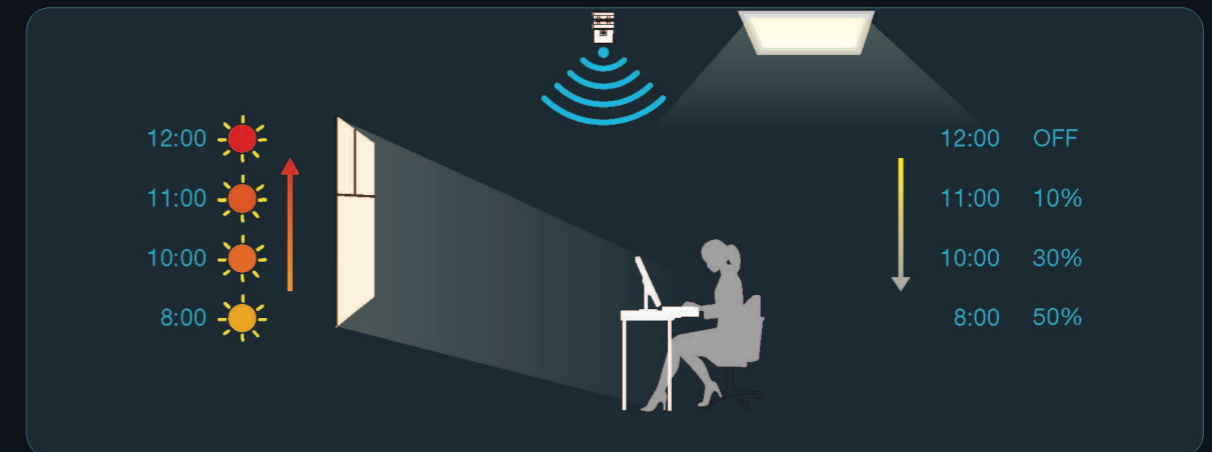

04. Breathing detection and posture recognition detection technology

Using 60GHz millimeter wave radar 4D imaging technology and using AI algorithm and deep self-learning, self-adaptive algorithm! Identify human walking track and posture detection (fall detection) and human presence detection!



Accurate Detection, Zero False Reports

- Strong anti-interference ability, energy concentration, large radiation gain;
- Strong transmitting/receiving capability, small side wave;
- Effectively solve the pain point through the wall.

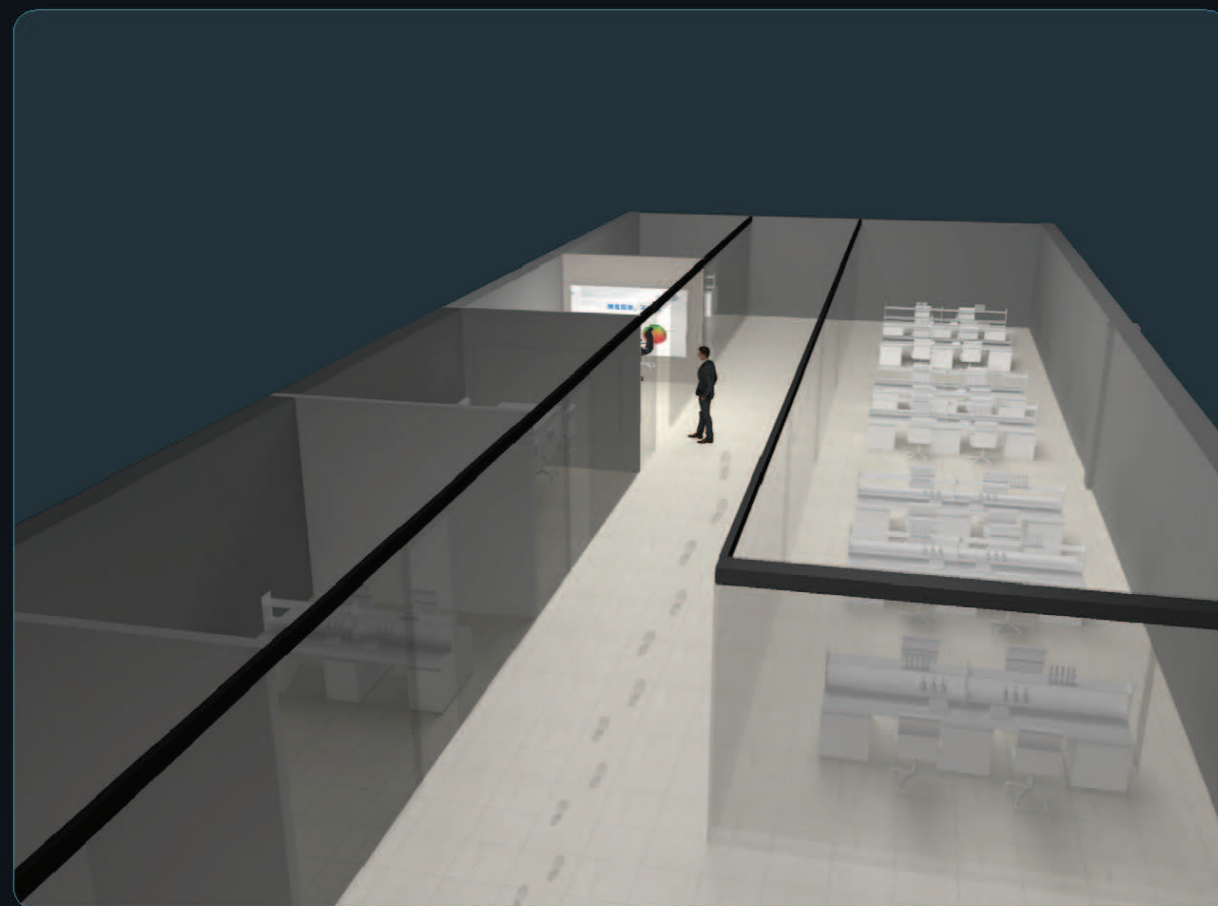
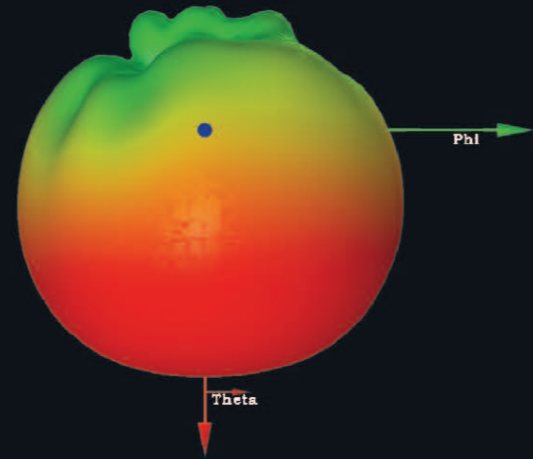

Accurate Detection, Zero Missing Reports

- Core patent horizontal half-wave backfolding antenna;
- Movement/true-presence detection;
- Suitable for large space range detection (8 ~ 10 meters);
- "0" false trigger rate;
- 99.999% detection accuracy;
- Multiple detection (sitting/standing/front, back, side, thick clothes, bedding, etc.).

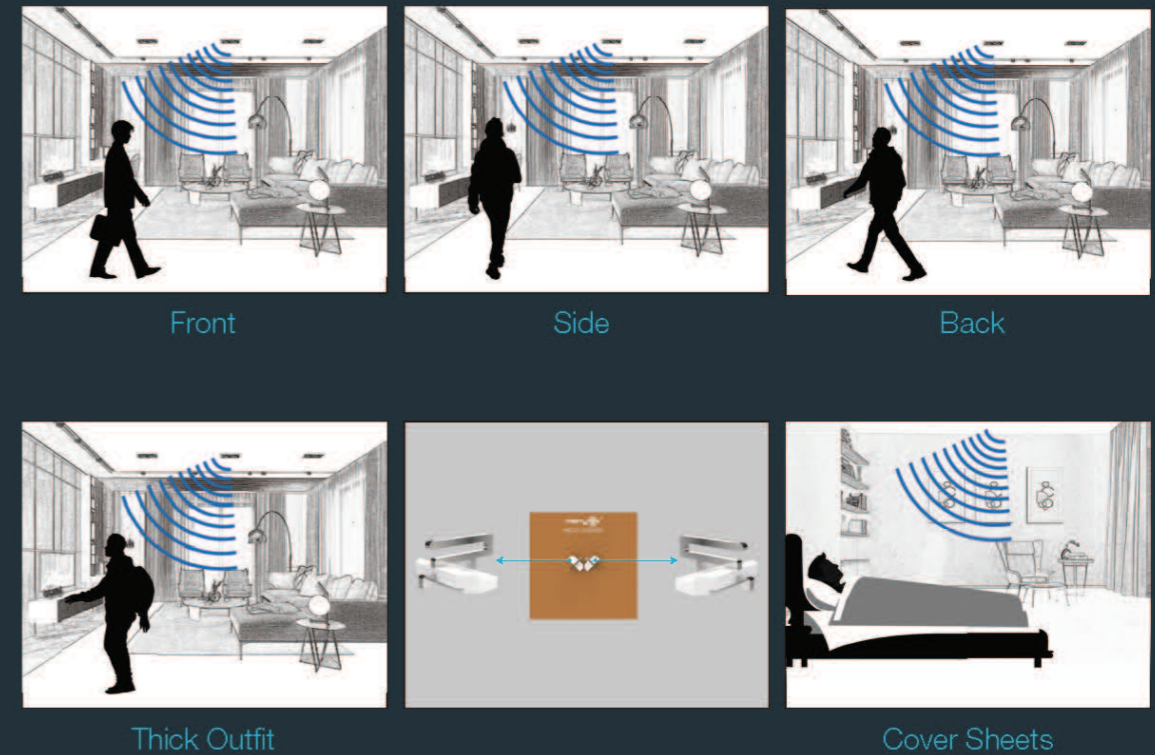

Single Items for Full Space Management



1 Balcony

Support multi-scene mode setting.



4 Corridor

The lamp is on while the man is walking.



2 Study room

Static detection to avoid turning off lights when needed.



5 Bedroom

When rest, the lights are low and the air conditioner is turned on.



3 Dining room

Existence detection, energy saving, intelligence.



6 Living room

Support multi-scene mode setting.

Security, Intelligence, Energy Saving, IOT

Movement | Minor motion | Breathing | Daylight



5.8GHz
LOW Impedance ANT

24GHz
Large beam millimeter wave radar



Smart Home



Smart Apartment



Smart Hotel

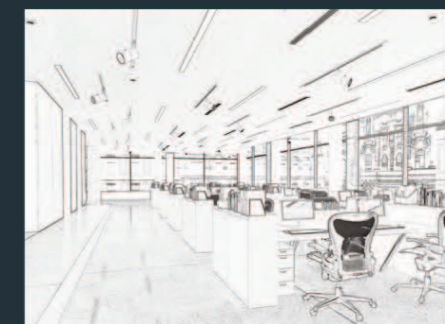

Smart Office



Smart Classroom



Elder Care

Scene Application Category

Intelligent Lighting

Villa/Home



Entrance



Living Room



Bedroom

School



Classroom



Bathroom



Balcony

Hotel



Passage



Guest Room



Bathroom

Commercial Office Building



Office Lobby



Office Area

Smart Home

Toilet



Smart Home System





Villa/Home (Entrance)

Entrance is the first space area that enters indoor, convenient come the first, But traditional touch control switch is not awkward when hands are not convenient. After entering the living room, the continuous operation demand for entrance lighting is not necessary, so the automatic motion control is more practical and significant.

Adopts anti-interference microwave motion detection technology to achieve stable, reliable and convenient application.

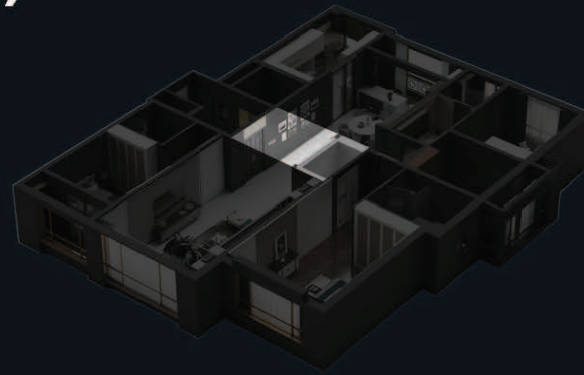

MSA001S 1

- 5.8Ghz microwave movement motion sensor ;
- Independent mounting, AC switch sensor;
- Super small opening size, beautiful and generous installation;
- Dip design for different settings adjustable;
- Active detection, quick response.



Villa/Home (Living Room)

The living room is the primary life carrier for the quality of life experience, and the application of sensing technology is the help and improvement of intelligent experience and qualified life. In a large space environment, especially in the movement and touch free activated lighting, the demand for occupancy detection will increase; when people are in a relatively static state, effective presence detection can be achieved by accurately detecting slight movement and breathing signals. It is necessary and critical for the application of intelligent lighting to work normally and stably. Adopts lifebing detection technology, which can accurately detect movement, slight movement and breathing signals to achieve real presence detection.

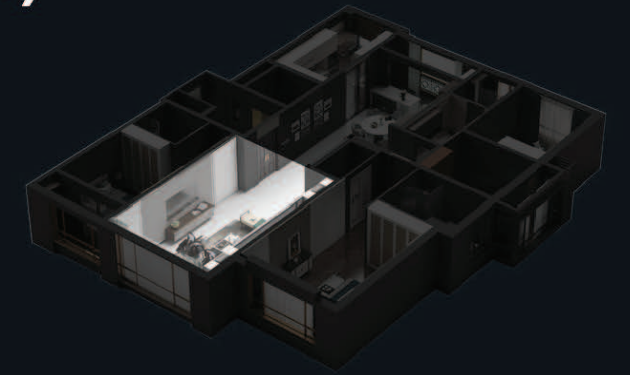

MSA201 Z

- 24GHz millimeter-wave radar lifebing presence sensor;
- Combine daylight sensor and millimeter wave presence sensor;
- Ultra-small cut hole size, beautiful and elegant installation;
- Integrate Tuya ZigBee communication, access Tuya intelligent control system in short time;
- Remote control/APP adjustable: Detection area/stand-by period/Daylight threshold.



MSA202S RC

- 24GHz millimeter-wave radar lifebing presence sensor;
- Standalone AC switch sensor, flush mounting;
- Ultra-small cut hole size, beautiful and elegant installation;
- Remote control/DIP switch adjustable: Detection area/Stand-by period/Daylight threshold.



MSA016S RC

- 5.8GHz lifebing presence radar sensor;
- Combine daylight sensor and radar presence sensor;
- DIP/remote control adjustable: Detection area/Stand-by period/Daylight threshold;
- The patented low-impedance antenna is used to effectively resist the interference of wireless signals such as 5G, WiFi, and Bluetooth.



Villa/Home (Bedroom)

The bedroom is a relatively private resting space. Comfort is the first requirement for bedroom lighting, and convenience in line with the application experience is the key boost to the first requirement.

The frequency and probability of slight movement and static maintenance are much higher than those of movement. The operation and maintenance of lighting, including low-light maintenance in semi-sleep state, and lighting off in sleep state. Neither can be satisfied by simple movement detection.

Adopts lifebing detection technology, which can accurately detect movement, slight movement and breathing signals to achieve real presence detection.



MSA201 Z

- 24GHz millimeter-wave radar lifebing presence sensor;
- Combine daylight sensor and millimeter wave presence sensor;
- Ultra-small cut hole size, beautiful and elegant installation;
- Integrate Tuya ZigBee communication, access Tuya intelligent control system in short time;
- Remote control/APP adjustable: Detection area/stand-by period/Daylight threshold.



MSA035 Z1

- 5.8GHz microwave radar lifebing presence sensor;
- Combine daylight sensor and millimeter wave presence sensor;
- Classic opening size, hidden and beautiful embedded;
- Integrate Tuya ZigBee communication, connect to Tuya intelligent control system in short time;
- Remote control/APP adjustable: Detection area/Stand-by period/Daylight threshold.



MSA050 Z1

- 5.8GHz microwave radar lifebing presence sensor;
- Combine daylight sensor and millimeter wave presence sensor;
- Classic opening size, hidden and beautiful embedded;
- Integrate Tuya ZigBee communication, connect to Tuya intelligent control system in short time;
- Remote control/APP adjustable: Detection area/Stand-by period/Daylight threshold.



MSA202S RC

- 24GHz millimeter-wave radar lifebing presence sensor;
- Standalone AC switch sensor, flush mounting;
- Ultra-small cut hole size, beautiful and elegant installation;
- Remote control/DIP switch adjustable: Detection area/Stand-by period/Daylight threshold.



MSA016S RC

- 5.8GHz lifebing presence radar sensor;
- Combine daylight sensor and radar presence sensor;
- DIP/remote control adjustable: Detection area/Stand-by period/Daylight threshold;
- The patented low-impedance antenna is used to effectively resist the interference of wireless signals such as 5G, WiFi, and Bluetooth.

Villa/Home (Bathroom)

The bathroom is usually a private space with relatively frequent functional applications. Different from the fast-frequency requirement of starting and closing the lighting of the entrance, the lighting of the bathroom needs a relatively long period of time. In addition to the need for rapid and sensitive detection, it is necessary to take into account the need for minor motion detection. And the maintenance of lighting operation under near-static conditions, the touch-free start and stop of lighting is a humanistic sublimation of intelligent and quality life. At the same time, it is particularly important to effectively resist and shield various wireless signal interference due to the high-frequency synchronous use of electronic products such as mobile phones.

Adopts lifebing detection technology, which can accurately detect movement, minor movement and breathing signals to achieve real presence detection.

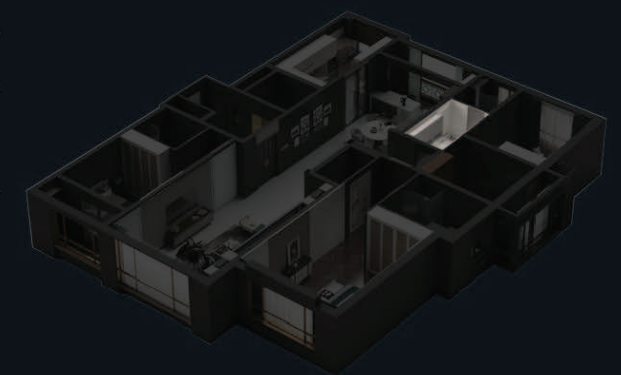



Villa/Home (Balcony)

The balcony is a quasi-outdoor space activity area, taking into account the auxiliary functions of housework (such as drying clothes, gardening, etc.) and leisure and relaxation functions. Analogy to the demand for lighting functions in the bathroom, the utilization rate of balcony lighting, especially the operation maintenance rate, is higher than that of entrance lighting. This determines that the practical value of presence sensing applications is higher than mobile.

In the face of the relatively high probability of mosquitoes, breezes, and leaf swings, the application needs to reduce the false trigger rate are particularly important.

Adopts the core patented algorithm to effectively resist false triggers caused by breeze, drizzle, birds and mosquitoes, and accurately detect movement, minor movement and breathing signals to achieve real presence detection.



MSA202S RC

- 24GHz millimeter-wave radar lifebing presence sensor;
- Standalone AC switch sensor, flush mounting;
- Ultra-small cut hole size, beautiful and elegant installation;
- Remote control/DIP switch adjustable: Detection area/Stand-by period/Daylight threshold.



MSA016S RC

- 6.8GHz lifebing presence radar sensor;
- Combine daylight sensor and radar presence sensor;
- DIP/remote control adjustable: Detection area/Stand-by period/Daylight threshold;
- The patented low-impedance antenna is used to effectively resist the interference of wireless signals such as 5G, WiFi, and Bluetooth.



Business Office Building (Office Lobby)

The lobby is the first business image and positioning business card after entering the office building, and it also carries basic business reception and negotiation functions.

Due to the needs of business functions, especially considering a period of stay and talks, simple movement detection applications cannot be satisfied.

A large number of commercial electronic products (such as mobile phones, tablets, notebook computers, etc.) will have a very high and frequent use probability, which requires accurate detection applications and effective resistance to And shielding all kinds of wireless signal interference is very important. Adopts lifebing detection technology, which can accurately detect movement, minor movement and breath-ing signals to achieve real presence detection.

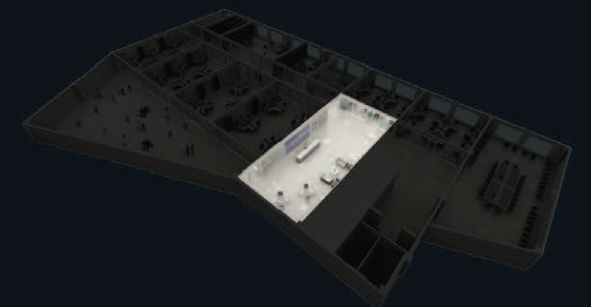

MSA201 Z

- 24GHz millimeter-wave radar lifebing presence sensor;
- Combine daylight sensor and millimeter wave presence sensor;
- Ultra-small cut hole size, beautiful and elegant installation;
- Integrate Tuya ZigBee communication, access Tuya intelligent control system in short time;
- Remote control/APP adjustable: Detection area/Stand-by period/Daylight threshold.



Business Office Building (Office Area)

The office area is the core functional area of a business office building, and basic office lighting and periodic lighting of meeting rooms are the primary requirements.

Electronic office is the basic norm. How to take into account the accuracy and stability of sensing applications and effectively ensure that it does not interfere with various wireless signals, which is a key indicator to measure the pros and cons of presence sensing applications.

At the same time, how to effectively reduce or even eliminate false triggers (such as when office personnel pass through the channel outside the conference room without anyone, sensors falsely trigger the lighting function of the conference room without anyone) is also an important evaluation and reference factor for application experience and electricity expenses.

LEDesta uses lifebeing detection technology and core patented algorithms, which can accurately detect movement, slight motion and breathing signals, eliminate false triggers, and achieve real presence detection and intelligent application experience.

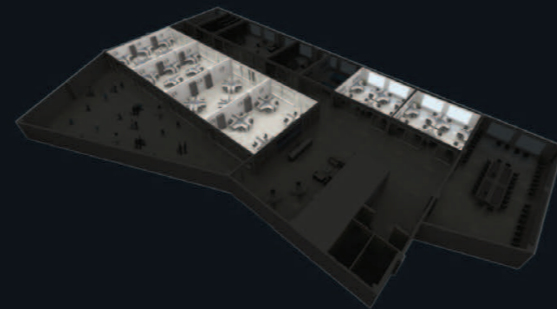

MSA200D RC

- 24GHz millimeter-wave radar lifebeing detection;
- Light sensing and millimeter-wave lifebeing detection are integrated;
- Ultra-small opening size, good appearance and easy installation;
- Dry contact input and suitable for many intelligent system;
- Set by remote control: detection area/hold time/daylight sensor.



MSA021D RC

- 5.8GHz radar lifebeing detection;
- Light sensing and radar lifebeing detection are integrated;
- Dry contact input and connect intelligent system quickly;
- Set by remote control: detection area/hold time/daylight sensor;
- The patented low-impedance antenna is used to effectively resist the interference of wireless signals such as 5G, WiFi, and Bluetooth.



MSA203D 485

- 24GHz millimeter-wave radar lifebeing detection;
- Light sensing and millimeter-wave lifebeing detection are integrated;
- Ultra-small opening size, good appearance and easy installation;
- 485 signal input and connect 485 bus quickly;
- Set by remote control/485 bus: detection area/hold time/daylight sensor.



MSA201 Z

- 24GHz millimeter-wave radar lifebeing presence sensor;
- Combine daylight sensor and millimeter wave presence sensor;
- Ultra-small cut hole size, beautiful and elegant installation;
- Integrate Tuya ZigBee communication, access Tuya intelligent control system in short time;
- Remote control/APP adjustable: Detection area/stand-by period/Daylight threshold.



MSA035 Z1

- 5.8GHz microwave radar lifebeing presence sensor;
- Combine daylight sensor and millimeter wave presence sensor;
- Classic opening size, hidden and beautiful embedded;
- Integrate Tuya ZigBee communication, connect to Tuya intelligent control system in short time;
- Remote control/APP adjustable: Detection area/Stand-by period/Daylight threshold.



MSA050 Z1

- 5.8GHz microwave radar lifebeing presence sensor;
- Combine daylight sensor and millimeter wave presence sensor;
- Classic opening size, hidden and beautiful embedded;
- Integrate Tuya ZigBee communication, connect to Tuya intelligent control system in short time;
- Remote control/APP adjustable: Detection area/Stand-by period/Daylight threshold.

Classroom

The classroom is the most important space area for teaching. With the upgrading of educational lighting, the application of detecting technology has become an important part.

Classrooms are relatively densely populated areas. With the emergence of COVID-19, reducing unnecessary hand contact has gradually become a habit and method, and detection light system has become a necessary requirement for health protection.

Different from the staged lighting operation of passages and corridors, the time of classroom lighting is relatively continuous, and students and teachers are in a relatively static and slight moving state, which requires accurate detection of slight moving and breathing signals to achieve effective presence detection, so as to ensure normal and stable operation of lighting.

LEDesta uses lifebeing detection technology, which can accurately detect movement, slight motion and breathing signals to achieve real presence detection.

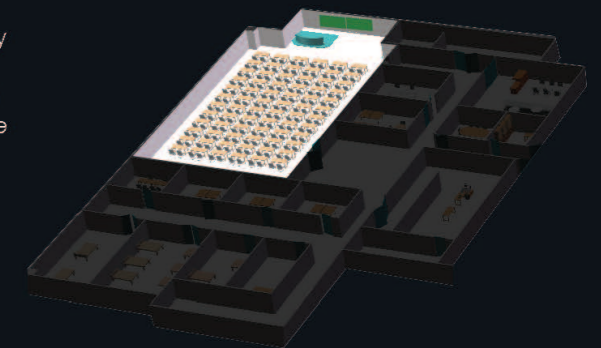



Hotel (Aisle)

Feeling at home is the goal of the hotel experience. The aisle is the first space area before entering the guest room to open the leisure experience except the hotel lobby.

The primary function of aisle lighting is to play a guiding role, while taking into account the energy cost of hotel operations, which determines that motion sensing applications are more suitable. The startup and operation of lighting directly affect the customer's check-in experience. Sensitivity and accuracy have become the primary factors for motion sensors.

Adopts anti-interference and positively detecting technology to achieve stable and reliable convenient application.



MSA001D

- 5.8GHz microwave radar motion sensor;
- Flush-mounted dry contact input sensor;
- Ultra-small opening size, good appearance and easy installation;
- Set by DIP switches: detection area/hold time/daylight sensor;
- Positively detecting and reacting quickly.



MSA001S 1

- 5.8GHz microwave radar motion sensor;
- Flush-mounted AC sensor with ON/OFF function;
- Ultra-small opening size, good appearance and easy installation;
- Set by DIP switches: detection area/hold time/daylight sensor;
- Positively detecting and reacting quickly.

Hotel (Guest Room)

Guest room is the key area of hotel leisure experience, comfort is the first requirement of guest room lighting, and convenience in line with application experience is the key boost to the first requirement.

The frequency and probability of fretting and static maintenance are much higher than those of movement. The operation and maintenance of lighting, including low-light maintenance in semi-sleep state, and lighting off in sleep state, Neither can be satisfied by simple mobile induction. Even if you feel at home, the guest room is not exactly the same as the bedroom at home. Electronic business office will occur from time to time with business travel. How to take into account the accuracy, stability and effective protection of sensing applications and the non-interference of various wireless signals is a measure of existence. A key indicator of the pros and cons of sensing applications.

Adopt patented lifebeing detected technology, which can detect movement, slight motion and breathing signal to achieve the true presence detection function.

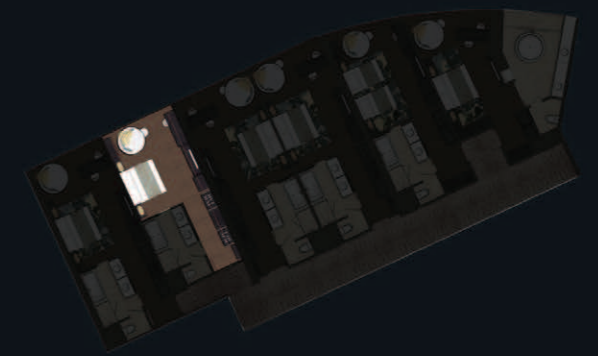

MSA201 Z

- 24GHz millimeter-wave radar lifebeing presence sensor;
- Combine daylight sensor and millimeter wave presence sensor;
- Ultra-small out hole size, beautiful and elegant installation;
- Integrate Tuya ZigBee communication, access Tuya intelligent control system in short time;
- Remote control/APP adjustable: Detection area/stand-by period/Daylight threshold.



MSA200D RC

- 24GHz millimeter-wave radar lifebeing detection;
- Light sensing and millimeter-wave lifebeing detection are integrated;
- Ultra-small opening size, good appearance and easy installation;
- Dry contact input and suitable for many intelligent system;
- Set by remote control: detection area/hold time/daylight sensor.



MSA203D 485

- 24GHz millimeter-wave radar lifebeing detection;
- Light sensing and millimeter-wave lifebeing detection are integrated;
- Ultra-small opening size, good appearance and easy installation;
- 485 signal input and connect 485 bus quickly;
- Set by remote control/485 bus: detection area/hold time/daylight sensor.



Hotel (Bathroom)

The bathroom is usually a private space with relatively frequent functional applications. While conveying the characteristic style of the hotel, convenience and comfort are also important.

Different from the corridor fast on off demand, bathroom lighting requires a relatively long period of time. In addition to the need for rapid and sensitive induction startup, it is necessary to take into account the maintenance of lighting operation under micro-motion and near-static conditions, without button touch. The controlled startup and shutdown of lighting is a consideration for both the customer and the hotel.

At the same time, due to some business travel factors, the office use of commercial electronic products will occur from time to time, and it is very necessary to effectively resist and shield various wireless signal interference.

Adopt patented lifebeing detected technology, which can detect movement, slight motion and breathing signal to achieve the true presence detection function.

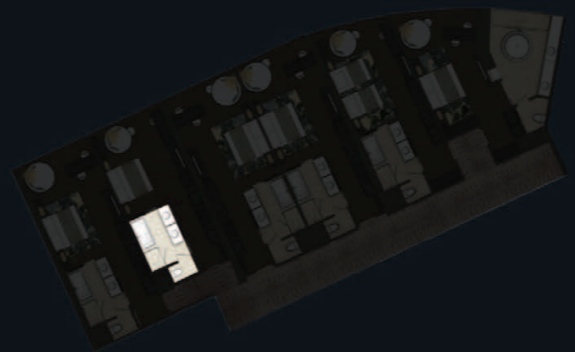

MSA200D RC

- 24GHz millimeter-wave radar lifebeing detection;
- Light sensing and millimeter-wave lifebeing detection are integrated;
- Ultra-small opening size, good appearance and easy installation;
- Dry contact input and suitable for many intelligent system;
- Set by remote control: detection area/hold time/daylight sensor.



MSA202S RC

- 24GHz millimeter-wave radar lifebeing presence sensor;
- Standalone AC switch sensor, flush mounting;
- Ultra-small cut hole size, beautiful and elegant installation;
- Remote control/DIP switch adjustable: Detection area/Stand-by period/Daylight threshold.

Smart Home (Toilet)

The toilet is an essential living tool. With the rise and development of intelligent applications, in addition to the most basic comfort requirements, convenience is one of the most important criteria.

For intelligent application experience, saving the inconvenience and even physical pain caused by bending over is a necessary factor for the application of mobile sensors.

The automatic lifting of the toilet seat has important requirements for distance and sensitivity. At the same time, due to various factors such as volume and installation, built-in matching is a prerequisite for intelligent applications. Adopts anti-interference positive detection technology and anti-multiple digital filter algorithm, which can accurately detect movement and realize stable and reliable convenient application.

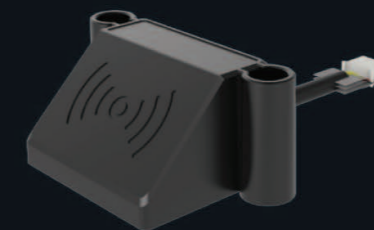
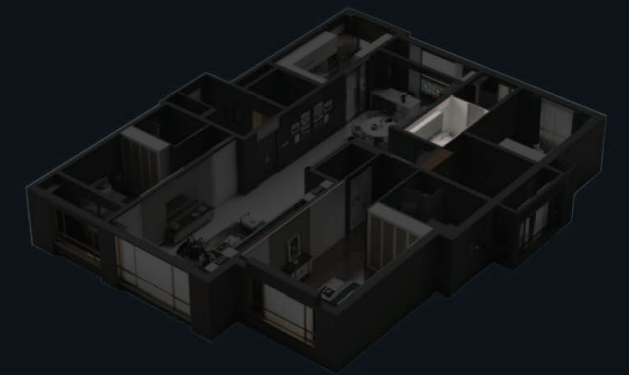

MC125D

- 24GHz millimeter wave radar precise motion sensing;
- 5-12V wide low voltage input, high and low level output;
- Ultra-small size, suitable for all smart toilets in the market;
- The sensing distance is precisely controlled at 0.5-1m;
- Built-in multiple filtering algorithms, effectively resist toilet interference.



Smart Home System

Smart home is the embodiment of IOT under the influence of the Internet. Taking the residence as a platform, through the Internet of Things technology, various devices in the home (such as audio and video equipment, lighting systems, curtain control, air conditioning control, security systems, digital cinema systems, audio and video servers, network appliances, etc.) are connected together, providing home appliance control, lighting control, telephone remote control, indoor and outdoor remote control, anti-theft alarm, environmental monitoring, HVAC control and programmable timing control, etc. functions and means. It not only has traditional residential functions, but also has building, network communication, information appliances, and equipment automation, and provides a full range of information interaction functions, and even saves money for various energy costs. Based on the needs of smart home systems, the accuracy and compatibility of sensors have become the primary reference factors for selection. Perfectly combines lifebeing detection technology with IOT to achieve true accurate detection and compatibility with intelligent systems.

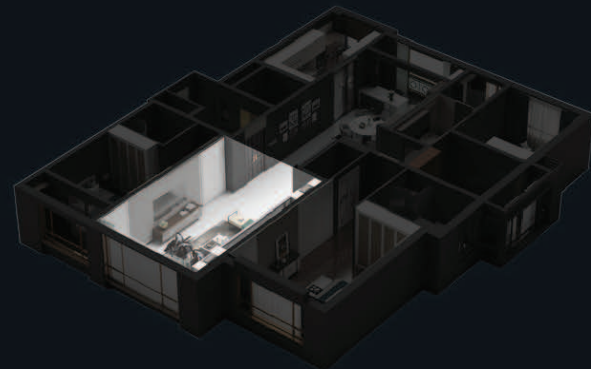

MSA201 Z

- 24GHz millimeter-wave radar lifebeing presence sensor;
- Combine daylight sensor and millimeter wave presence sensor;
- Ultra-small out hole size, beautiful and elegant installation;
- Integrate Tuya ZigBee communication, access Tuya intelligent control system in short time;
- Remote control/APP adjustable: Detection area/stand-by period/Daylight threshold.



MSA200D RC

- 24GHz millimeter-wave radar lifebeing detection;
- Light sensing and millimeter-wave lifebeing detection are integrated;
- Ultra-small opening size, good appearance and easy installation;
- Dry contact input and suitable for many intelligent system;
- Set by remote control: detection area/hold time/daylight sensor.



MSA203D 485

- 24GHz millimeter-wave radar lifebeing detection;
- Light sensing and millimeter-wave lifebeing detection are integrated;
- Ultra-small opening size, good appearance and easy installation;
- 485 signal input and connect 485 bus quickly;
- Set by remote control/485 bus: detection area/hold time/daylight sensor.

Product Parameter Instruction

5.8GHz Lifebeing Sensor-Dry Contact Output

Lifebeing Sensor MSA021D RC / MSA021 RC



MSA021D RC / MSA021 RC

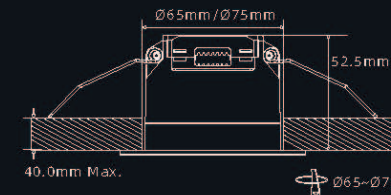

Specifications

[Product Model] MSA021D RC (Low Voltage Dry Contact)
 [Working Voltage] 12-24V DC operate
 [Rated Load] 36V 50mA max
 [Working Mode] Dry contact (normally open)
 [Detection Technology] Lifebeing detection + light detection
 [Operating Frequency] 5.8 GHz ± 75 MHz, ISM band
 [Transmission Power] 5mW Max.
 [Detection Area] 100%/75%/50%/25%
 [Hold Time] 5s/30s/1min/3min/5min/10min/20min/30min
 [Brightness] 5lux/25lux/50lux/Disable
 [Installation Method] Surfaced installation
 [Cut Size] φ65-75mm
 [Working Temperature] 0-50°C
 [IP rating] IP20

[Product Model] MSA021 RC (High Voltage Dry Contact)
 [Working Voltage] 120-277V AC operate
 [Rated Load] 36V 50mA max
 [Working Mode] Dry contact (normally open)
 [Detection Technology] Lifebeing detection + light detection
 [Operating Frequency] 5.8 GHz ± 75 MHz, ISM band
 [Transmission Power] 5mW Max.
 [Detection Area] 100%/75%/50%/25%
 [Hold Time] 5s/30s/1min/3min/5min/10min/20min/30min
 [Brightness] 5lux/25lux/50lux/Disable
 [Installation Method] Surfaced installation
 [Cut Size] φ65-75mm
 [Working Temperature] 0-50°C
 [IP rating] IP20

5.8GHz Motion Sensor-Dry Contact Output Motion sensor MSA001D



MSA001D
(Ceiling Mounting)



MSA001D
(Surfaced Mounting)

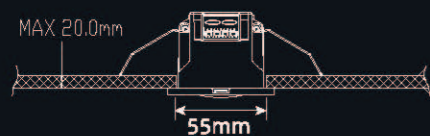

Specifications

- [Product Model] MSA001D (Low Voltage Dry Contact)
- [Working Voltage] 12-24V DC
- [Working Current] ≤ 50mA
- [Working Mode] Dry contact (normally open)
- [Detection Technology] Movement detection
- [Operating Frequency] 5.8 GHz ±75 MHz, ISM band
- [Transmission Power] 0.5mW Max.
- [Detection Area] 100%/75%/50%/25% (set by DIP switches)
- [Hold Time] 5s/1min/6min/10min (set by DIP switches)
- [Daylight Sensor] 5lux/30lux/50lux/Disable (set by DIP switches)
- [Installation Method] Surfaced Mounting
- [Out Size] φ55mm
- [Working Temperature] 0-50°C
- [IP Rating] IP20

5.8GHz Lifebeing Sensor-Dry Contact Output Lifebeing Sensor MSA040D RC



MSA040D RC

Specifications

- [Product Model] MSA040D RC (Low Voltage Dry Contact)
- [Working Voltage] 12-24V DC operate
- [Rated Load] 36V 50mA max
- [Working Mode] Dry contact (Normally open)
- [Detection Technology] Lifebeing detection + light detection
- [Operating Frequency] 5.8 GHz ±75 MHz, ISM band
- [Transmission Power] 5mW Max.
- [Detection Area] 100%/75%/50%/25%
- [Hold Time] 5s/30s/1min/3min/5min/10min/20min/30min
- [Daylight Sensor] 5lux/30lux/50lux/100lux/150lux /Disable (Diffuse reflection)
- [Installation Method] Ceiling installation
- [Dimension] φ105x23mm
- [Working Temperature] 0-50°C
- [IP Rating] IP20



5.8GHz Lifebeing Sensor-Single Items Output

Lifebeing Sensor MSA015S RC / MSA025S



MSA015S RC



MSA025S

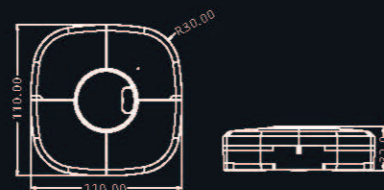
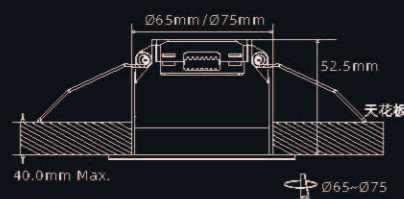

Specifications

- 【Product Model】 MSA015S RC
- 【Working Voltage】 120-277VAC, 50/60Hz
- 【Load Capacity】 400W (Inductive) ; 800W (Resistive)
- 【Stand-by Power】 $\leq 0.5W$
- 【Working Mode】 ON/OFF function
- 【Detection Technology】 Lifebeing detection + light detection
- 【Operating Frequency】 5.8 GHz ± 75 MHz, ISM band
- 【Transmission Power】 5mW Max.
- 【Detection Area】 100%/75%/50%/25%
- 【Hold Time】 5s/30s/1min/3min/5min/10min/20min/30min
- 【Daylight Sensor】 5-150lux, Disable
- 【Installation Method】 Surfaced mounting
- 【Cut Size】 $\phi 65-\phi 75mm$
- 【Working Temperature】 0-50°C
- 【IP Rating】 IP20

- 【Product Model】 MSA025S
- 【Working Voltage】 120-277VAC, 50/60Hz
- 【Load Capacity】 400W (Inductive) ; 800W (Resistive)
- 【Stand-by Power】 $\leq 0.5W$
- 【Working Mode】 ON/OFF function
- 【Detection Technology】 Lifebeing detection + light detection
- 【Operating Frequency】 5.8 GHz ± 75 MHz, ISM band
- 【Transmission Power】 5mW Max.
- 【Detection Area】 100%/75%/50%/25%
- 【Hold Time】 5s/30s/1min/3min/5min/10min/20min/30min
- 【Daylight Sensor】 5-150lux, Disable
- 【Installation Method】 Ceiling mounting
- 【Dimension】 110x110x32mm
- 【Working Temperature】 0-50°C
- 【IP Rating】 IP20

5.8GHz Motion Sensor-Single Items Output

Motion sensor MSA001S 1

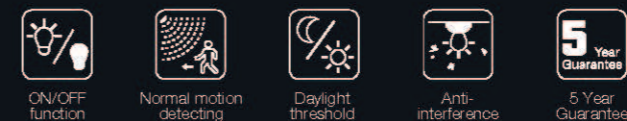

MSA001S 1
(Ceiling Mounting)



MSA001S 1
(Surfaced Mounting)

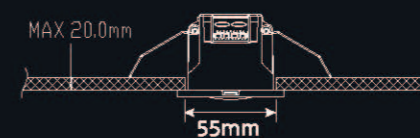

Specifications

- 【Product Model】 MSA001S 1
- 【Working Voltage】 120-277V AC 50Hz/60Hz
- 【Load Capacity】 400W (Inductive) ; 800W (Resistive)
- 【Stand-by Power】 $\leq 0.5W$
- 【Working Mode】 ON/OFF function
- 【Detection Technology】 Movement detection
- 【Operating Frequency】 5.8 GHz ± 75 MHz, ISM band
- 【Transmission Power】 5mW Max.
- 【Detection Area】 100%/75%/50%/25% (set by DIP switches)
- 【Hold Time】 5s/1min/5min/10min (set by DIP switches)
- 【Daylight Sensor】 5lux/30lux/50lux/Disable (set by DIP switches)
- 【Installation Method】 Surfaced mounting
- 【Cut Size】 $\phi 65mm$
- 【Working Temperature】 0-50°C
- 【IP Rating】 IP20

5.8GHz Motion Sensor-Single Items Output

Motion Sensor MSA003S RC (elongated induction zone)



Elongated induction area pattern

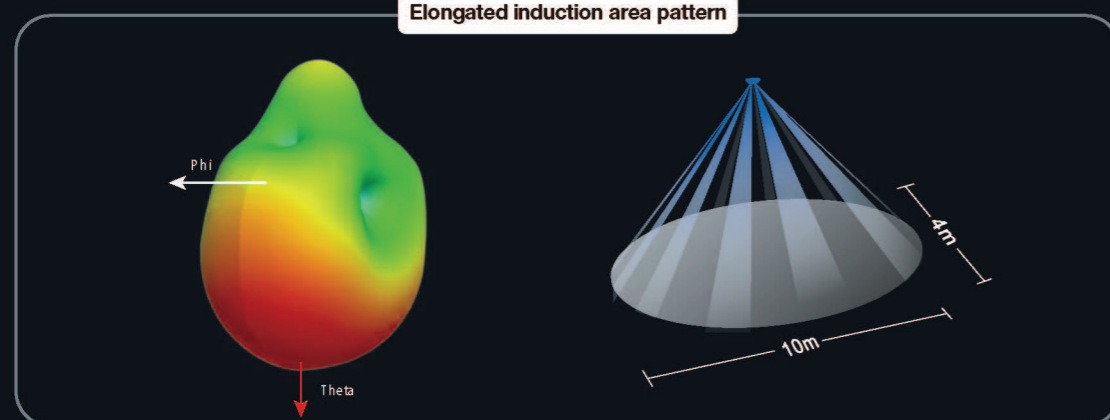

Specifications

- 【Product Model】 MSA003S RC
- 【Working Voltage】 120-277VAC, 50/60Hz
- 【Load Capacity】 400W (Inductive) ; 800W (Resistive)
- 【Stand-by Power】 ≤1W
- 【Working Mode】 ON/OFF function
- 【Detection Technology】 Movement detection + light detection
- 【Operating Frequency】 5.8 GHz ±75 MHz, ISM band
- 【Transmission Power】 5mW Max.
- 【Detection Area】 100%/75%/50%/25%
- 【Hold Time】 5s/30s/1min/3min/5min/10min/20min/30min
- 【Daylight Sensor】 5-150lux, Disable
- 【Installation Method】 Ceiling mounting
- 【Dimension】 110x110x32mm
- 【Working Temperature】 0-50°C
- 【IP Rating】 IP20

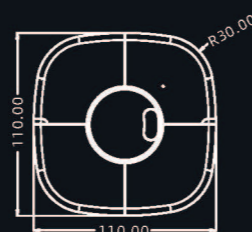

5.8GHz Lifebeing Sensor-Wired Communication Signal Output

Lifebeing Sensor MSA017K RC



MSA017K RC

Specifications

- 【Product Model】 MSA017K RC (KNX output)
- 【Working Voltage】 24-30v dc (KNX bus power supply)
- 【Working Current】 ≤15mA (30V)
- 【Communication Method】 KNX
- 【Detection Technology】 Lifebeing detection + light detection
- 【Operating Frequency】 5.8 GHz ±75 MHz, ISM band
- 【Programming Key】 Press mask
- 【Transmission Power】 5mW Max.
- 【Detection Area】 100%/75%/50%/25%/10%
- 【Daylight Sensor】 1-60000 lux
- 【Installation Method】 Surfaced mounting
- 【Cut Size】 φ55-65mm
- 【Working Temperature】 0-50°C
- 【IP Rating】 IP20

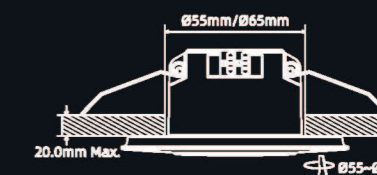

5.8GHz Lifebeing Sensor-Wired Communication Signal Output Lifebeing Sensor MSA036D 485 / MSA043D 485



MSA036D 485



MSA043D 485

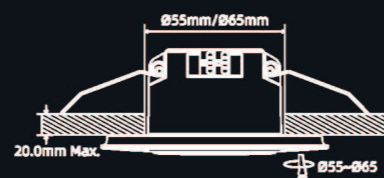
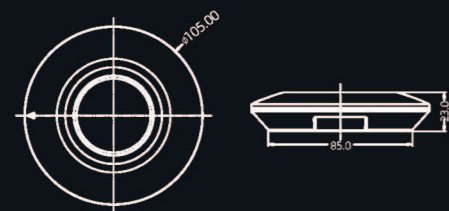

Specifications

- 【Product Model】 MSA036D 485
- 【Working Voltage】 12-24v dc
- 【Working Current】 27±2mA @12V DC
- 【Communication Method】 Merrytek RS485 Protocol
- 【Detection Technology】 Lifebeing detection + light detection
- 【Operating Frequency】 5.8 GHz ±75 MHz, ISM band
- 【Transmission Power】 5mW Max.
- 【Detection Area】 100%/75%/50%/25%
(set by remote control or serial port)
- 【Daylight Level Change】 10-100Lux (daylight level is reported when light change value exceeds the preset value)
- 【Daylight Level Range】 0 -1200Lux
(collected below the sensor, height of 3m)
- 【Installation Method】 Surfaced mounting
- 【Dimension】 φ105x23mm
- 【Working Temperature】 0-50°C
- 【IP Rating】 IP20

- 【Product Model】 MSA043D 485
- 【Working Voltage】 12-24v dc
- 【Working Current】 27±2mA @12V DC
- 【Communication Method】 Merrytek RS485 Protocol
- 【Detection Technology】 Lifebeing detection + light detection
- 【Operating Frequency】 5.8 GHz ±75 MHz, ISM band
- 【Transmission Power】 5mW Max.
- 【Detection Area】 100%/75%/50%/25%
(set by remote control or serial port)
- 【Daylight Level Change】 10-100Lux (daylight level is reported when light change value exceeds the preset value)
- 【Daylight Level Range】 0 -1200Lux
(collected below the sensor, height of 3m)
- 【Installation Method】 Ceiling mounting
- 【Cut Size】 φ55-65mm
- 【Working Temperature】 0-50°C
- 【IP Rating】 IP20

5.8GHz Lifebeing Sensor-Wired Communication Signal Output Lifebeing Sensor MSA019 / MSA039 PLC



MSA019 / MSA039 PLC

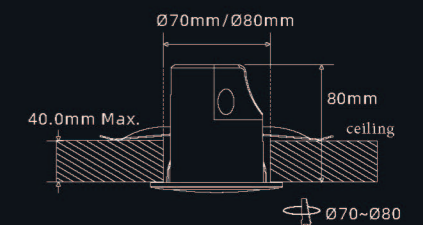

Specifications

- 【Product Model】 MSA019 (DALI 1 output)
- 【Working Voltage】 120-277VAC 50/60Hz
- 【Load Capacity】 64pcs DALI drive
- 【Working Mode】 On-off, DALI dimming/constant light
- 【Detection Technology】 Lifebeing detection + light detection
- 【Operating Frequency】 5.8 GHz ±75 MHz, ISM band
- 【Transmission Power】 5mW Max.
- 【Detection Area】 100%/75%/50%/25%
- 【Hold Time】 5s/30s/1min/3min/5min/10min/20min/30min
- 【Daylight Harvesting】 5-1000lux
- 【Installation Method】 Surfaced mounting
- 【Cut Size】 φ70-80mm
- 【Working Temperature】 0-50°C
- 【IP Rating】 IP20

- 【Product Model】 MSA039 PLC (PLC output)
- 【Working Voltage】 120-277V AC
- 【Stand-by Power】 ≤1.5w
- 【Working Mode】 Serial communication protocol
- 【Detection Technology】 Lifebeing detection + light detection
- 【Operating Frequency】 5.8 GHz ±75 MHz, ISM band
- 【Transmission Power】 5mW Max.
- 【Detection Area】 100%/75%/50%/25%
- 【Hold Time】 5s/30s/1min/3min/5min/10min/20min/30min
- 【Daylight Harvesting】 5-1000lux
- 【Installation Method】 Surfaced mounting
- 【Cut Size】 φ70-80mm
- 【Working Temperature】 0-50°C
- 【IP Rating】 IP20

5.8GHz Lifebeing Sensor-Wireless Communication Signal Output Lifebeing Sensor MSA035 Z1 / MSA050 Z1



MSA035 Z1



MSA050 Z1

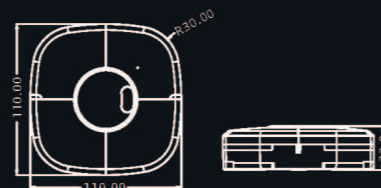
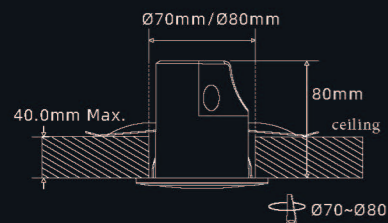

Specifications

- 【Product Model】 MSA035 Z1 (Tuya ZigBee)
- 【Working Voltage】 120-277V AC, 50Hz/60Hz
- 【Stand-by Power】 ≤1W
- 【Communication Method】 Tuya ZigBee
- 【Detection Technology】 Lifebeing detection + light detection
- 【Operating Frequency】 5.8 GHz ±75 MHz, ISM band
- 【Transmission Power】 5mW Max.
- 【Detection Area】 100%/75%/50%/25%
(set by remote control or Tuya App)
- 【Hold Time】 30s/1min/2min/3min/5min/10min/20min
- 【Daylight Detection】 Monitoring ambient lux level (5-1200lux) and reporting every 30sec. Immediately report if lux abruptly change. Lux change value (10lux-100lux) can be set in App.
- 【Installation Method】 Surfaced mounting
- 【Cut Size】 φ70-80mm
- 【Working Temperature】 0-50°C
- 【IP Rating】 IP20

- 【Product Model】 MSA050 Z1 (Tuya ZigBee)
- 【Working Voltage】 120-277V AC, 50Hz/60Hz
- 【Stand-by Power】 ≤1W
- 【Communication Method】 Tuya ZigBee
- 【Detection Technology】 Lifebeing detection + light detection
- 【Operating Frequency】 5.8 GHz ±75 MHz, ISM band
- 【Transmission Power】 5mW Max.
- 【Detection Area】 100%/75%/50%/25%
(set by remote control or Tuya App)
- 【Hold Time】 30s/1min/2min/3min/5min/10min/20min
- 【Daylight Detection】 Monitoring ambient lux level (5-1200lux) and reporting every 30sec. Immediately report if lux abruptly change. Lux change value (10lux-100lux) can be set in App.
- 【Installation Method】 Ceiling mounting
- 【Dimension】 110x110x32mm
- 【Working Temperature】 0-50°C
- 【IP Rating】 IP20

5.8GHz Lifebeing Sensor-Wireless Communication Signal Output Lifebeing Sensor MSA042D Z

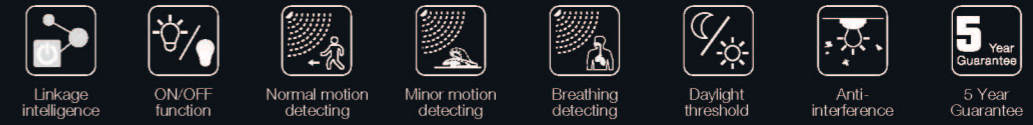

MSA042D Z

Specifications

- 【Product Model】 MSA042D Z (Tuya ZigBee)
- 【Working Voltage】 12-24V DC
- 【Working Current】 45±2mA @12V DC
- 【Communication Method】 Tuya ZigBee
- 【Detection Technology】 Lifebeing detection + light detection
- 【Operating Frequency】 5.8 GHz ±75 MHz, ISM band
- 【Transmission Power】 5mW Max.
- 【Detection Area】 100%/75%/50%/25%/0% (set by remote control or Tuya App)
- 【Hold Time】 30s/1min/2min/3min/5min/10min/20min (set by remote control or Tuya App)
- 【Daylight Range】 0 -1200Lux (collected below the sensor, height of 3m)
- 【Installation Method】 Surfaced mounting
- 【Cut Size】 φ55-65mm
- 【Working Temperature】 0-50°C
- 【IP Rating】 IP20

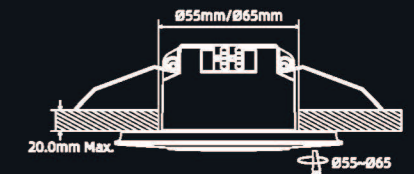

5.8GHz Lifebeing Sensor-Wireless Communication Signal Output

Lifebeing Sensor MSA035 Z1 / MSA050 Z1

(Public version-can dock any wireless signal of customers)

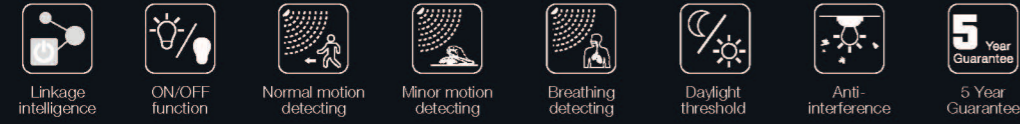

MSA035 Z1



MSA050 Z1

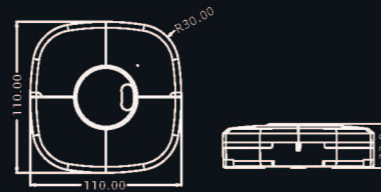
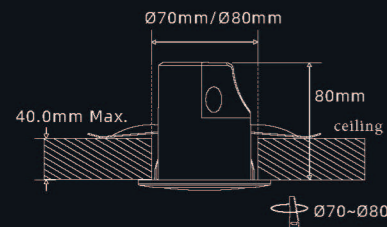

Specifications

- 【Product Model】 MSA035 Z1 (Public version)
- 【Working Voltage】 120-277V AC, 50Hz/60Hz
- 【Stand-by Power】 ≤0.5W
- 【Communication Method】 Customer communication module
- 【Detection Technology】 Lifebeing detection + light detection
- 【Operating Frequency】 5.8 GHz ±75 MHz, ISM band
- 【Transmission Power】 5mW Max.
- 【Detection Area】 100%/75%/50%/25%
(set by remote control or Tuya App)
- 【Hold Time】 30s/1min/2min/3min/5min/10min/20min
- 【Daylight Detection】 Every 30s, the relevant data of illuminance value is transmitted to the 2.4GHz ZigBee module, if the illuminance value changes suddenly, report it immediately. Sudden change value
- 【Installation Method】 Surfaced mounting
- 【Cut Size】 φ70-80mm
- 【Working Temperature】 0-50°C
- 【IP Rating】 IP20

- 【Product Model】 MSA050 Z1 (Public version)
- 【Working Voltage】 120-277V AC, 50Hz/60Hz
- 【Stand-by Power】 ≤0.5W
- 【Communication Method】 Customer communication module
- 【Detection Technology】 Lifebeing detection + light detection
- 【Operating Frequency】 5.8 GHz ±75 MHz, ISM band
- 【Transmission Power】 5mW Max.
- 【Detection Area】 100%/75%/50%/25%
(set by remote control or Tuya App)
- 【Hold Time】 30s/1min/2min/3min/5min/10min/20min
- 【Daylight Detection】 Every 30s, the relevant data of illuminance value is transmitted to the 2.4GHz ZigBee module, if the illuminance value changes suddenly, report it immediately. Sudden change value
- 【Installation Method】 Ceiling mounting
- 【Dimension】 110x110x32mm
- 【Working Temperature】 0-50°C
- 【IP Rating】 IP20

5.8GHz Lifebeing Sensor-0-10V Output

Lifebeing Sensor MSA012R / MSA012



MSA012R / MSA012

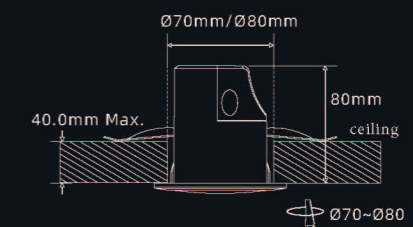

Specifications

- 【Product Model】 MSA012R
- 【Working Voltage】 120-277VAC, 50/60Hz
- 【Stand-by Power】 ≤1W
- 【Load Capacity】 800W (Inductive) ; 1000W (Resistive)
- 【Working Mode】 On-off / step dimming
- 【Detection Technology】 Lifebeing detection + light detection
- 【Operating Frequency】 5.8 GHz ±75 MHz, ISM band
- 【Transmission Power】 5mW Max.
- 【Detection Area】 100%/75%/50%/25%
- 【Hold Time】 5s~30min
- 【Stand-by Dim Level】 10%/20%/30%/50%
- 【Stand-by Period】 0s~30min
- 【Daylight Harvesting】 0-2000lux
- 【Installation Method】 Surfaced mounting
- 【Cut Size】 φ70-80mm
- 【Working Temperature】 0-50°C
- 【IP Rating】 IP20

- 【Product Model】 MSA012
- 【Working Voltage】 120-277VAC, 50/60Hz
- 【Stand-by Power】 ≤1W
- 【Load Capacity】 800W (Inductive) ; 1000W (Resistive)
- 【Working Mode】 On-off / step dimming
- 【Detection Technology】 Movement detection + light detection
- 【Operating Frequency】 5.8 GHz ±75 MHz, ISM band
- 【Transmission Power】 5mW Max.
- 【Detection Area】 100%/75%/50%/25%
- 【Hold Time】 5s~30min
- 【Stand-by Dim Level】 10%/20%/30%/50%
- 【Stand-by Period】 0s~30min
- 【Daylight Harvesting】 0-2000lux
- 【Installation Method】 Surfaced mounting
- 【Cut Size】 φ70-80mm
- 【Working Temperature】 0-50°C
- 【IP Rating】 IP20

24GHz Lifebeing Sensor-Dry Contact Output

Lifebeing Sensor MSA200D RC / MSA200 RC



MSA200D RC



MSA200 RC

24GHz Lifebeing Sensor-Single Items Output

Lifebeing Sensor MSA202S RC



MSA202S RC
(Ceiling mounting)



MSA202S RC
(Surfaced mounting)

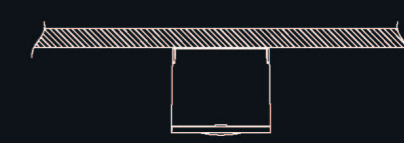
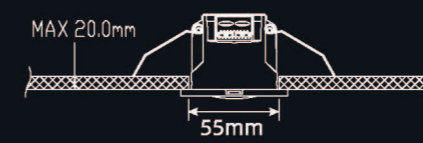
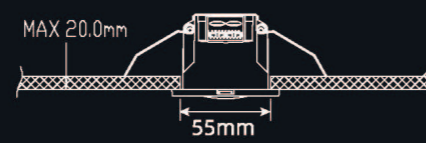
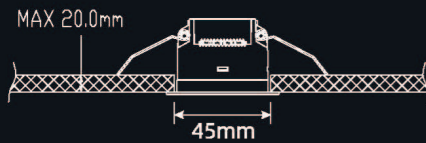

Specifications

[Product Model] MSA200D RC (Low Voltage Dry Contact)
[Working Voltage] 12-24V DC
[Working Current] @12Vdc: 50mA max @24Vdc: 30mA max
[Rated Load] 36V 50mA max
[Working Mode] Dry contact (normally open)
[Detection Technology] Lifebeing detection + light detection
[Operating Frequency] 24GHz -24.25GHz
[Transmission Power] 5mW Max.
[Detection Area] 100%/75%/50%/25%
[Hold Time] 5s/30s /1min / 3min /5min /10min /20min
[Daylight Sensor] 5lux/15lux/30lux/50lux/100lux/150lux/Disable
[Installation Method] Surfaced mounting
[Cut Size] ϕ 45mm
[Working Temperature] 0-50°C
[IP Rating] IP20

[Product Model] MSA200 RC (High Voltage Dry Contact)
[Working Voltage] 120-277V AC 50/60Hz
[Stand-by Power] \leq 0.5W
[Rated Load] 36V 50mA max
[Working Mode] Dry contact (normally open)
[Detection Technology] Lifebeing detection + light detection
[Operating Frequency] 24GHz -24.25GHz
[Transmission Power] 5mW Max.
[Detection Area] 100%/75%/50%/25%
[Hold Time] 5s/30s /1min / 3min /5min /10min /20min
[Daylight Sensor] 5lux/15lux/30lux/50lux/100lux/150lux/Disable
[Installation Method] Surfaced mounting
[Cut Size] ϕ 55mm
[Working Temperature] 0-50°C
[IP Rating] IP20

Specifications

[Product Model] MSA202S RC
[Working Voltage] 120-277Vac, 50/60Hz
[Stand-by Power] \leq 0.5W
[Working Mode] On-off
[Detection Technology] Lifebeing detection + light detection
[Operating Frequency] 24GHz -24.25GHz
[Transmission Power] 5mW Max.
[Detection Area] 100%/75%/50%/25% (by remote MH10 or dip switches)
[Hold Time] 5s/30s/1min/3min/5min/10min/20min (by remote MH10)
 5s/30s/1min/3min/5min (by dip switches)
[Daylight sensor] 50lux/Disable (by dip switches)
 5lux/15lux/30lux/50lux/100lux/150lux/Disable (by remote MH10)
[Installation Method] Surfaced mounting
[Cut Size] ϕ 55mm
[Working Temperature] 0-50°C
[IP Rating] IP20

24GHz Lifebeing Sensor-Wired Communication Signal Output Lifebeing Sensor MSA201 PLC



MSA201 PLC
(Ceiling mounting)



MSA201 PLC
(Surfaced mounting)



Specifications

- [Product Model] MSA201 PLC (PLC output)
- [Working Voltage] 120-277V AC
- [Stand-by Power] < 2W
- [Working Current] @12Vdc: 30mA max @24Vdc: 15mA max
- [Communication Method] PLC
- [Detection Technology] Lifebeing detection + light detection
- [Operating Frequency] 24GHz -24.25GHz
- [Transmission Power] 5mW Max.
- [Detection Area] 100%/75%/50%/25%
- [Hold Time] 5s/30s/1min/3min/5min/10min/20min
- [Daylight Detection] Every 30s, the relevant data of illuminance value is transmitted to the PLC module, and if the illuminance value changes suddenly, it will be reported immediately (the sudden change value is 10-100lux, which can be set through the serial port).
- [Installation Method] Surfaced mounting
- [Out Size] $\phi 55\text{mm}$
- [Working Temperature] 0-50°C
- [IP Rating] IP20

24GHz Lifebeing Sensor-Wired Communication Signal Output Lifebeing Sensor MSA203D 485



MSA203D 485
(Ceiling mounting)



MSA203D 485
(Surfaced mounting)



Specifications

- [Product Model] MSA203D 485 (485 output)
- [Working Voltage] 12-24V DC
- [Working Current] 38±2mA @12V DC
- [Communication Method] RS485
- [Detection Technology] Lifebeing detection + light detection
- [Operating Frequency] 24GHz -24.25GHz
- [Transmission Power] 5mW Max.
- [Detection Area] 0%-100% (MH10 remote control settings 25%/50%/75%/100%; Serial port setting 0%-100%)
- [Hold Time] 30s/1min/2min/3min/5min/10min/20min/30min
(compatible with MH10 remote control or serial port setting 2s-7200s)
5s/30s/1min/3min/5min (by dip switches)
- [Daylight Detection] When the variation of ambient illuminance meets the preset illuminance difference, the sensor immediately reports the ambient illuminance value. Sudden change value (10-100lux), which can be set through serial port.
- [Installation Method] Surfaced mounting
- [Out Size] $\phi 45\text{mm}$
- [Working Temperature] 0-50°C
- [IP Rating] IP20

24GHz Lifebeing Sensor-Wired Communication Signal Output

Lifebeing Sensor MSA206K RC



MSA206K RC

Specifications

- [Product Model] MSA206K RC (KNX output)
- [Working Voltage] KNX power supply: 30V DC @3±1 mA
Auxiliary power supply: 12V DC @42±3mA
- [Working Current] ≤15mA (30V)
- [Communication Method] KNX
- [Detection Technology] Lifebeing detection + light detection
- [Programming Key] Press mask
- [Operating Frequency] 24GHz -24.26GHz
- [Transmission Power] 5mW Max.
- [Detection Area] ETS settings: 10%/20%/30%/40%/50%/60%/70%/80%/90%/100%
Setting of remote controller MH10: 25%/50%/75%/100%
- [Hold Time] ETS settings: 1s-30min
Setting of remote controller MH10:
5s/30s/1min/3min/5min/10min/20min/30min
- [Daylight Detection] When the variation of ambient illuminance meets the preset illuminance difference, the sensor immediately reports the ambient illuminance value.
Sudden change value (10-2000lux), which can be set by ETS.
- [Installation Method] Surfaced mounting
- [Cut Size] φ55-65mm
- [Working Temperature] 0-50°C
- [IP Rating] IP20

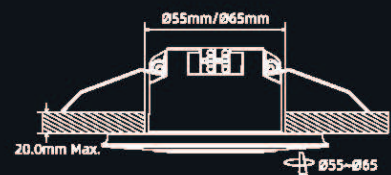

24GHz Lifebeing Sensor-Wireless Communication Signal Output

Lifebeing Sensor MSA201 Z/ MSA201 Z Gongban



MSA201 Z
(Ceiling mounting)



MSA201 Z
(Surfaced mounting)

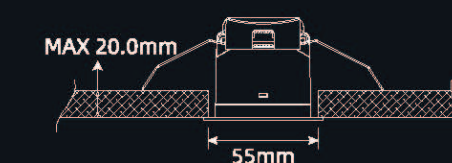

Specifications

- [Product Model] MSA201 Z (Tuya ZigBee)
- [Working Voltage] 220-240Vac, 50/60Hz
- [Stand-by Power] ≤1W
- [Communication Method] Tuya ZigBee
- [Detection Technology] Lifebeing detection + light detection
- [Operating Frequency] 24GHz -24.26GHz
- [Transmission Power] 5mW Max.
- [Detection Area] 0%/25%/50%/75%/100%, (set by Tuya App)
- [Hold Time] 30s/1min/2min/3min/5min/10min /20min/30min,
(set by Tuya App)
- [Daylight Detection] When the variation of ambient illuminance meets the preset illuminance difference, the sensor immediately reports the ambient illuminance value. Sudden change value (10-100lux), which can be set through the APP.
- [Installation Method] Surfaced mounting
- [Cut Size] φ55mm
- [Working Temperature] 0-50°C
- [IP Rating] IP20

- [Product Model] MSA201 Z (Any wireless signal of the customer can be docked)
- [Working Voltage] 220-240Vac, 50/60Hz
- [Stand-by Power] ≤1W
- [Communication Method] Tuya ZigBee
- [Detection Technology] Lifebeing detection + light detection
- [Operating Frequency] 24GHz -24.26GHz
- [Transmission Power] 5mW Max.
- [Detection Area] 0%/25%/50%/75%/100%, (set by Tuya App)
- [Hold Time] 30s/1min/2min/3min/5min/10min /20min/30min,
(set by Tuya App)
- [Daylight Detection] When the variation of ambient illuminance meets the preset illuminance difference, the sensor immediately reports the ambient illuminance value. Sudden change value (10-100lux), which can be set through the APP.
- [Installation Method] Surfaced mounting
- [Cut Size] φ55mm
- [Working Temperature] 0-50°C
- [IP Rating] IP20

24GHz Motion Sensor-Wireless Communication Signal Output

Motion Sensor MSA053 Z



MSA053 Z
(Ceiling mounting)



MSA053 Z
(Surfaced mounting)



Specifications

- 【Product Model】 MSA053 Z (Tuya ZigBee)
- 【Working Voltage】 220-240Vac 50Hz/60Hz
- 【Stand-by Power】 ≤1W
- 【Communication Method】 Tuya ZigBee
- 【Detection Technology】 Movement detection
- 【Operating Frequency】 24GHz -24.26GHz
- 【Transmission Power】 5mW Max.
- 【Detection Area】 25%/50%/75%/100% (can be set by infrared remote control MH10)
Setting by APP: 0%/10%/20%/30%/40%/50%/60%/70%/80%/90%/100%
- 【Hold Time】 Setting by Infrared Remote Control MH10: 5s/30s/1min/2min/3min/5min/ 10min/20min/30min
Setting by APP: 5s/30s/1min/2min/3min/5min/ 10min/20min/30min
- 【Installation Method】 Surfaced mounting
- 【Cut Size】 ϕ 55mm
- 【Working Temperature】 0-50°C
- 【IP Rating】 IP20

24GHz Lifebeing Sensor-0-10V Output

Lifebeing Sensor MSA207D RC



MSA207D RC

Specifications

- 【Product Model】 MSA207D RC
- 【Working Voltage】 12V DC
- 【output】 0-10V Dimming signal
- 【Stand-by Power】 ≤0.35W
- 【Detection Technology】 Lifebeing detection
- 【Operating Frequency】 24GHz -24.26GHz
- 【Transmission Power】 5mW Max.
- 【Detection Area】 0%/25%/50%/75%/100%, (by remote MH10 or dip switches)
- 【Hold Time】 30s/1min/2min/3min/5min/10min /
20min/30min, (by remote MH10 or dip switches)
- 【Daylight Detection】 5lux/15lux/30lux/50lux/100lux/150lux/Disable
- 【Working Temperature】 0-50°C
- 【IP Rating】 IP20

Daylight Series
Daylight MS10



MS10 A

MS10 B



Daylight harvesting

Specifications

- 【Working Voltage】 1-10V dc
- 【Working Voltage】 1-10v dimming
- 【Color Coding Of Cable】 Red+, Black-
- 【Cable Length】 80cm
- 【Max. Current Sink】 50mA Max.(1-10v port current)
- 【Working Temperature】 -25-50°C
- 【IP Rating】 IP20

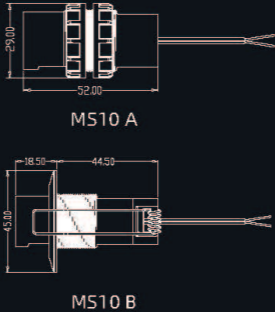

Daylight Series
Daylight MS13



Daylight harvesting

Specifications

- 【Power Supply Mode】 DALI bus power supply
- 【Detection Technology】 Light induction (constant light)
- 【Communication Method】 Standard DALI signal
- 【Working Mode】 Switch/Dimming Instruction
- 【Installation Mode】 Ceiling mounting
- 【Dimension】 $\phi 105 \times 23 \text{mm}$
- 【Installation Mode】 -25-50°C
- 【IP Rating】 IP20

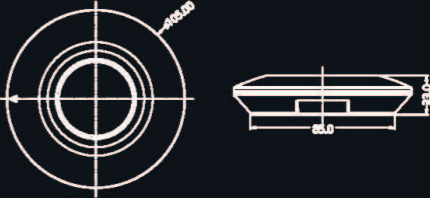

Remote control Series

Remote control Nr.1

| Button | Remarks |
|--------|--|
| | Press "ON/OFF" button. When the load lamp enters the mode normal or off, press "RESET" button to exit the mode normal on or off. |
| | Press "reset" button to return all settings back to current DIP settings. |
| | Press the "Sensor motion" button. Switch from on/off mode to inductive mode (function return subject to the last setting) |
| | N/A |
| | N/A |
| | N/A |
| | N/A |
| | N/A |
| | HS: Turn ON indicator light LS: Turn OFF indicator light |
| | Light sensor Setting Disable |
| | N/A |
| | Hold time Setting: 5S/30S/1min/3min/5min/10min/20min/30min |
| | N/A |
| | Detection area Setting: 25%/50%/75%/100% |
| | Remote Distance Toggling the button can set the distance of remote control controlling sensor. |

Remote control Series

Remote control Nr.2

| Remote Control Settings | Button | Remarks |
|-------------------------|--------|---|
| | | Short press to set detection area 25% / 50% / 75% / 100%, long press (>3s) to transmit selected value. |
| | | Short press to transmit all selected value on remote screen. |
| | | Short press to set standby period 0S / 30S / 1min / 3min / 5min / 10min / 20min / 30min / +∞, Long press >3s to transmit selected value |
| | | Short press to set standby dimming level 10% / 20% / 30% / 50%. Long press >3s to transmit selected value |
| | | Short press to set hold time 0S / 30S / 1min / 3min / 5min / 10min / 20min / 30min / +∞, Long press >3s to transmit selected value |
| | | Short press to set working mode: MD=Motion+daylight threshold, MP=Motion +Daylight priority (daylight switch) / Daylight harvesting, P=Daylight priority / Daylight harvesting Long press >3s to transmit selected mode Note: MP or P is not available for all models, please follow spec. sheet of motion sensor |
| | | Short press to set Daylight threshold 5Lux / 15Lux / 30Lux / 50Lux / 100Lux / 160Lux / Disable. Long press >3s to transmit selected value When set Daylight threshold to Disable, sensor will switch on light when detect motion regardless of ambient brightness level. |
| | | Short press to quit from constant on/off mode, sensor start to work (the previous setting stays in validity) |
| | | Short press to set occupancy light level 50%-100% in MD mode; set target lux level in MP(Motion+Daylight harvesting) mode Dim level will change 5% each time press this button |
| | | Short press to return to factory default setting. |
| | | NA for user |
| | | Short press to set high H sensitivity (open area application) / L low sensitivity (applied in reflection surface around area) As this remote is standard product, not all models have this function. Please refer specification of sensors. |
| | | 2nd optional quick setting, short press to show the setting configuration, long press >3s to save this configuration. Press "Send" to transmit selected quick setting |
| | | 1st optional quick setting, short press to show the setting configuration, long press >3s to save this configuration. Press "Send" to transmit selected quick setting |
| | | Short press to switch on/off light, sensor function will recover after turn off and on power Long press >3s to switch on/off light, sensor function won't recover only if press "Motion sensor" |